

ISSUING LOCAL AUTHORITY



PART 1 – PREMISES & LICENCE HOLDER DETAILS

POSTAL ADDRESS OF PREMISES, OR IF NONE, ORDNANCE SURVEY MAP REFERENCE OR DESCRIPTION

@Home, 5 Bridge Street, Salisbury, Wiltshire, SP1 2ND

NAME, (REGISTERED) ADDRESS AND CONTACT DETAILS OF HOLDER OF PREMISES LICENCE

@ Home Salisbury Ltd
Clearway Garage House, Firsdwn, Salisbury, Wiltshire, SP4 6DT

REGISTERED NUMBER OF HOLDER, FOR EXAMPLE COMPANY NUMBER, CHARITY NUMBER

11335739

NAME, ADDRESS AND TELEPHONE NUMBER OF DESIGNATED PREMISES SUPERVISOR WHERE THE PREMISES LICENCE AUTHORISES THE SUPPLY OF ALCOHOL

Ms Louella Adamson
[REDACTED]

ISSUING AUTHORITY AND PERSONAL LICENCE NUMBER HELD BY DESIGNATED PREMISES SUPERVISOR WHERE THE PREMISES LICENCE AUTHORISES FOR THE SUPPLY OF ALCOHOL

Wiltshire Council LN/14881

WHERE THE LICENCE IS TIME LIMITED - THE DATES AND TIMES

Not Applicable

WHERE THE LICENCE AUTHORISES SUPPLIES OF ALCOHOL WHETHER THESE ARE ON AND / OR OFF SUPPLIES

ON Sales only

STATE WHETHER ACCESS TO THE PREMISES BY CHILDREN IS RESTRICTED OR PROHIBITED

Where applicable the provisions of Section 145 of the Licensing Act 2003 apply

PART 2 – LICENSABLE ACTIVITIES & TIMINGS

LICENSABLE ACTIVITIES AUTHORISED BY THE LICENCE						
Licensable activities	Location	Day	Time From	Time To	Time From	Time To
Perform Play Exhibit Film Live Music Recorded Music Perform Dance Similar to Making Music/Dance	Indoors	Sunday	10:00	22:00		
		Monday	10:00	22:00		
		Tuesday	10:00	22:00		
		Wednesday	10:00	22:00		
		Thursday	10:00	22:00		
		Friday	10:00	22:00		
		Saturday	10:00	22:00		
Non Standard Timings & Seasonal Variations	New Year's Eve until 02:00hrs. Members Only Events once a month from 22:00hrs to 02:00hrs - Authorities will be notified in writing 14 days in advance					
Alcohol Sales	ON Sales	Sunday	10:00	22:00		
		Monday	10:00	22:00		
		Tuesday	10:00	22:00		
		Wednesday	10:00	22:00		
		Thursday	10:00	22:00		
		Friday	10:00	22:00		
		Saturday	10:00	22:00		
Non Standard Timings & Seasonal Variations	New Year's Eve until 02:00hrs. Members Only Events once a month from 22:00hrs to 02:00hrs - Authorities will be notified in writing 14 days in advance					
Hrs premises open to public	.The Whole Premises	Sunday	10:00	22:30		
		Monday	10:00	22:30		
		Tuesday	10:00	22:30		
		Wednesday	10:00	22:30		
		Thursday	10:00	22:30		
		Friday	10:00	22:30		
		Saturday	10:00	22:30		
Non Standard Timings & Seasonal Variations	New Year's Eve until 02:30hrs.Members Only Events once a month from 22:00hrs to 02:30hrs - Authorities will be notified in writing 14 days in advance					

Licence Commencement Date

6th August 2018

Current Licence Date

2nd November 2018

Licensing Officer

Licensing Officer

ANNEX 1 - MANDATORY CONDITIONS

Supply of Alcohol

1. Where this Licence authorises the supply of alcohol:

No supply of alcohol may be made under this licence:

- (a) At a time when there is no Designated Premises Supervisor in respect of the Premises Licence
- (b) At a time when the Designated Premises Supervisor does not hold a Personal Licence or his Personal Licence is suspended

Every retail sale or supply of alcohol made under this licence must be made or authorised by a person who holds a Personal Licence.

Exhibition of Films

1. Where a premises licence authorises the exhibition of films, the licence must include a condition requiring the admission of children to the exhibition of any film to be restricted in accordance with this section.
2. Where the film classification body is specified in the licence, unless subsection (3)(b) applies, admission of children must be restricted in accordance with any recommendation by that body.
3. Where:-
 - (a) The film classification body is not specified in the licence, or
 - (b) The relevant licensing authority has notified the holder of the licence that this subsection applies to the film in question,

admission of children must be restricted in accordance with any recommendation made by that licensing authority.

4. In this section “children” means any person aged under 18; and

“film classification body” means the person or persons designated as the authority under Section 4 of the Video Recordings Act 1984(c39) (authority to determine suitability of video works for classification).

Irresponsible Promotions

1. The responsible person must ensure that staff on relevant premises do not carry out, arrange or participate in any irresponsible promotions in relation to the premises.
2. In this paragraph, an irresponsible promotion means any one or more of the following activities, or substantially similar activities, carried on for the purpose of encouraging the sale or supply of alcohol for consumption on the premises—
 - (a) games or other activities which require or encourage, or are designed to require or encourage, individuals to—
 - i. drink a quantity of alcohol within a time limit (other than to drink alcohol sold or supplied on the premises before the cessation of the period in which the responsible person is authorised to sell or supply alcohol), or
 - ii. drink as much alcohol as possible (whether within a time limit or otherwise);

- (b) provision of unlimited or unspecified quantities of alcohol free or for a fixed or discounted fee to the public or to a group defined by a particular characteristic in a manner which carries a significant risk of undermining a licensing objective;
- (c) provision of free or discounted alcohol or any other thing as a prize to encourage or reward the purchase and consumption of alcohol over a period of 24 hours or less in a manner which carries a significant risk of undermining a licensing objective;
- (d) selling or supplying alcohol in association with promotional posters or flyers on, or in the vicinity of, the premises which can reasonably be considered to condone, encourage or glamorise anti-social behaviour or to refer to the effects of drunkenness in any favourable manner;
- (e) dispensing alcohol directly by one person into the mouth of another (other than where that other person is unable to drink without assistance by reason of disability)

Free Tap Water

1. The responsible person must ensure that free potable tap water is provided on request to customers where it is reasonably available. (*This means that responsible persons at all premises must ensure customers are provided with potable (drinking) water for free if they ask for it.*)

Age Verification Policy

1.
 - (a) The premises licence holder or club premises certificate holder must ensure that an age verification policy is adopted in respect of the premises in relation to the sale or supply of alcohol.
 - (b) The designated premises supervisor in relation to the premises licence must ensure that the supply of alcohol at the premises is carried on in accordance with the age verification policy.
 - (c) The policy must require individuals who appear to the responsible person to be under 18 years of age (or such older age as may be specified in the policy) to produce on request, before being served alcohol, identification bearing their photograph, date of birth and either—
 - i. a holographic mark, or.
 - ii. an ultraviolet feature.

Drink Volume Measures

1. The responsible person shall ensure that:
 - (a) where any of the following alcoholic drinks is sold or supplied for consumption on the premises (other than alcoholic drinks sold or supplied having been made up in advance ready for sale or supply in a securely closed container) it is available to customers in the following measures:
 - i. beer or cider: ½ pint;
 - ii. gin, rum, vodka or whisky: 25 ml or 35 ml; and
 - iii. still wine in a glass: 125 ml; and
2. these measures are displayed in a menu, price list or other printed material which is available to customers on the premises; and.
3. where a customer does not in relation to a sale of alcohol specify the quantity of alcohol to be sold, the customer is made aware that these measures are available.

Permitted Price

1.
 - (a) A relevant person shall ensure that no alcohol is sold or supplied for consumption on or off the premises for a price which is less than the permitted price.
 - (b) For the purposes of the condition set out in paragraph 1—
 - A. “duty” is to be construed in accordance with the Alcoholic Liquor Duties Act 1979;
 - B. “permitted price” is the price found by applying the formula—
$$P = D + (D \times V)$$
where—
 - i. P is the permitted price,
 - ii. D is the amount of duty chargeable in relation to the alcohol as if the duty were charged on the date of the sale or supply of the alcohol, and
 - iii. V is the rate of value added tax chargeable in relation to the alcohol as if the value added tax were charged on the date of the sale or supply of the alcohol;
 - C. “relevant person” means, in relation to premises in respect of which there is in force a premises licence—
 - i. the holder of the premises licence,
 - ii. the designated premises supervisor (if any) in respect of such a licence, or
 - iii. the personal licence holder who makes or authorises a supply of alcohol under such a licence;
 - D. “relevant person” means, in relation to premises in respect of which there is in force a club premises certificate, any member or officer of the club present on the premises in a capacity which enables the member or officer to prevent the supply in question; and
 - E. “value added tax” means value added tax charged in accordance with the Value Added Tax Act 1994.
2. Where the permitted price given by Paragraph B of paragraph 2 would (apart from this paragraph) not be a whole number of pennies, the price given by that sub-paragraph shall be taken to be the price actually given by that sub-paragraph rounded up to the nearest penny.
3. (1) Sub-paragraph (2) applies where the permitted price given by Paragraph B of paragraph 2 on a day (“the first day”) would be different from the permitted price on the next day (“the second day”) as a result of a change to the rate of duty or value added tax.
(2) The permitted price which would apply on the first day applies to sales or supplies of alcohol which take place before the expiry of the period of 14 days beginning on the second day.

Door Supervision (except theatres, cinemas, bingo halls and casinos)

1. Where a premises licence includes a condition that at specified times one or more individuals must be at the premises to carry out a security activity, each such individual must:
 - (a) be authorised to carry out that activity by a licence granted under the Private Security Industry Act 2001; or
 - (b) be entitled to carry out that activity by virtue of section 4 of the Act.
2. But nothing in subsection (1) requires such a condition to be imposed:
 - (a) in respect of premises within paragraph 8(3)(a) of Schedule 2 to the Private Security Industry Act 2001 (c12) (premises with premises licences authorising plays or films); or

(b) in respect of premises in relation to:

- i. any occasion mentioned in paragraph 8(3)(b) or (c) of that Schedule (premises being used exclusively by club with club premises certificate, under a temporary event notice authorising plays or films or under a gaming licence), or
- ii. any occasion within paragraph 8(3)(d) of that Schedule (occasions prescribed by regulations under that Act).

3. For the purposes of this section:

- (a) "security activity" means an activity to which paragraph 2(1)(a) of that Schedule applies, and, which is licensable conduct for the purposes of that Act, (see Section 3(2) of that Act) and
- (b) paragraph 8(5) of that Schedule (interpretation of references to an occasion) applies as it applies in relation to paragraph 8 of that Schedule.

ANNEX 2A – CONVERTED CONDITIONS

- None

ANNEX 2B – OPERATING SCHEDULE

PREVENTION OF PUBLIC NUISANCE

- External exit door to remain shut, except for access and egress. Staff are to monitor this, especially between the hours of 21:00 and 00:00.
- Staff/management to control noise levels, if too high, levels will be reduced accordingly.
- Siting of speakers will be located in areas that are sufficient enough to inhibit noise into public areas.
- At closing time, staff will be positioned to deter customers from being too loud outside of the premises (smoking area). Staff are to highlight to customers where the taxi ranks are and to advise them to disperse quietly.
- Litter bins will be positioned to encourage customers to place rubbish into the bins; staff will check the outside areas for litter following the premises closing.
- Empty bottles will not be emptied during unsociable hours.
- The premises licence holder and/or DPS will ensure that music and noise from customers from the premises is inaudible in the hotel section of the Kings Head Inn (or any equivalent successor premises in the same location).
- The premises licence holder and/or DPS will install a noise limiter in the premises through which all amplified music or voices must be played and its levels set in order to achieve compliance with condition 1 above, after consultation with the appointed representative of JD Wetherspoon PLC. Wiltshire Council's licensing department are to be informed, in writing, of the agreed level.
- Such levels shall not be capable of adjustment above the levels set by the management of the premises except with prior written authority of Wiltshire Council's Licensing Department.
- The premises licence holder shall ensure that the rear yard of the premises is maintained in a clean and tidy state and litter is stored in appropriate lidded and secure receptacles located with the demise of the premises whilst awaiting collection and does not obstruct the fire exit of the premises at any time.

PUBLIC SAFETY

- On normal operating nights, no glass/bottles will be taken out of the premises.
- Plastic drink containers will be provided, where necessary.
- Staff to monitor inside and outside of premises for any vulnerable persons who may need help and support.
- For the safe evacuation of the public from the premises, the capacity limit will be set at 170; staff to monitor this.
- Staff will conduct a pre-opening safety checks prior to the premises opening to the public; a daily check list form will be used and filed.
- Regular checks of all fire safety equipment and PAT testing on all essential electrical equipment will be conducted by a qualified person, records will be maintained.
- Fire safety signs will be in place by the main entrance and rear fire exit doors; signs will be displayed throughout highlighting the route to the fire exits, these will be maintained on a regular basis, by competent staff. Records will be maintained.
- Approved emergency lighting will be in place, which will be able to provide 3 hours of light and ability to be recharged, when normal lighting is restored. This will be maintained by an approved, qualified person and records will be maintained.
- Staff will receive basic fire training, and management to conduct a practice fire evacuation drill with staff, at least twice a year. Records of training and practice drill to be maintained.

PROTECTION OF CHILDREN FROM HARM

- First Floor Area – Under 13's will be accompanied by their parent(s) or guardian from the hours of 15:00 to 18:00 at all times. At least one member of staff will be DBS checked to the level of enhanced and will be present during operating hours.
- Lower Floor Areas – 13 to 17 year olds will be allowed in these areas from 10:00 to 19:00. No alcohol will be sold during these times. Staff to monitor areas during operating times, to ensure safety and no unauthorised consuming of alcohol is taking place.
- The premise will have an age verification policy in place, challenge 25 signage will be placed at the bar area and front door. ID's that will be accepted are the following: Valid passport, UK driving licence and accepted proof of age scheme cards. Staff will be given training on the premises age verification policy.

PREVENTION OF CRIME AND DISORDER

- Staff to be vigilant and pro-active in dealing with issues relating to anti-social behaviour, in all areas of the premises.
- Front of house to monitor customer's behaviour prior to entering the premises and where necessary, politely refuse entry, or explain house rules on anti-social behaviour.
- CCTV in place, covering essential internal and front door areas. Signs will be positioned at the front entrance. Date and time recorded and logs kept for inspection. The system will be maintained by approved, qualified person.
- Premises to be an active member of Pubwatch and to employ and use, where necessary, radio communication, linked to CCTV and other members of Pubwatch.

- Staff to be proactive in looking for any potential drug related issues. Management to have in place signage, in appropriate areas highlighting the zero tolerance approach the premises has to use.
- An incident book will be maintained at the premises.
- Instruction, training and supervision on the Licensing Act 2003 will take place.

ANNEX 3 – CONDITIONS ATTACHED AFTER HEARING

- None

ANNEX 4 – PLANS

Attached Separately
Dated: 26/06/2018 x 3

Plumbing

Single stack soil and vent pipe system to be provided with 100mm diameter soil and vent pipe receiving waste vent pipes to be taken to terminate at floor and opening into building within 2m of floor to be completed with approved terminal cap vent pipe to be 75mm diameter above highest appliance waste fitting

ventilation

OUTLET to be provided with mechanical extract ventilation capable of extracting not less than 15 litres per second which may be operated intermittently
Background ventilation to toilets to be provided by proposed windows filled with trickle ventilation
Other areas to be ventilated by opening windows and doors where appropriate with background ventilation provided by trickle ventilators to windows/doors (background ventilation openings having a total area of not less than 8000mm²)

Window and Extractor fans

Important note

Windows french casements and doors to be provided with frame vent to satisfy above requirement

COPY

NOTE

Fire alarm system fitted to rear section
Emergency lighting fitted to fire fighting compartment
Fire exits to be self closing and smoke seal fitted

- (H1) H101
- (H2) H102
- (H3) H103
- (H4) H104
- (H5) H105
- (H6) H106
- (H7) H107
- (H8) H108
- (H9) H109
- (H10) H110

LICENSING AUTHORITY
CERTIFIED COPY *Gau Spond*
DATE 26/6/18

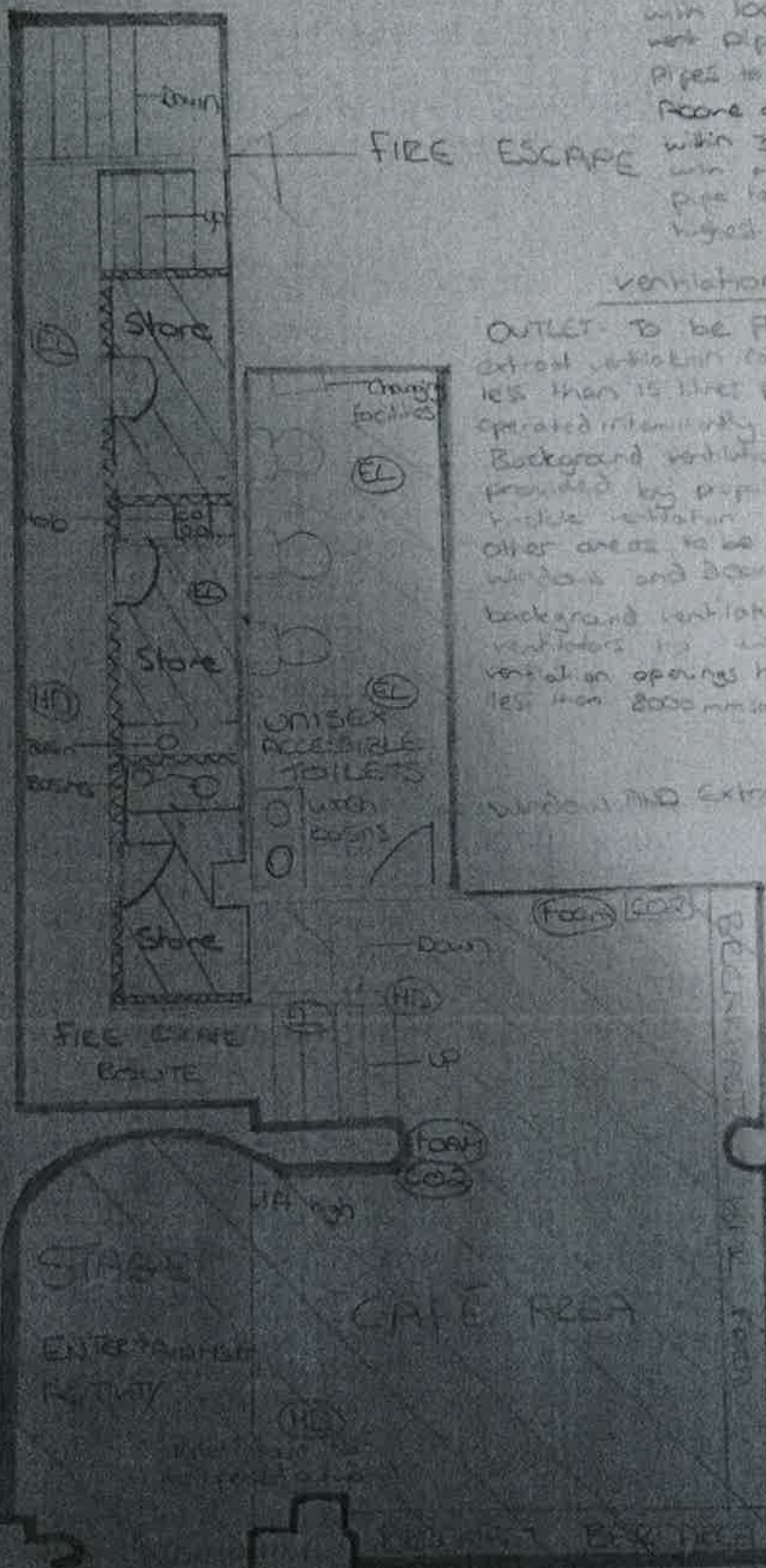

26/7/18

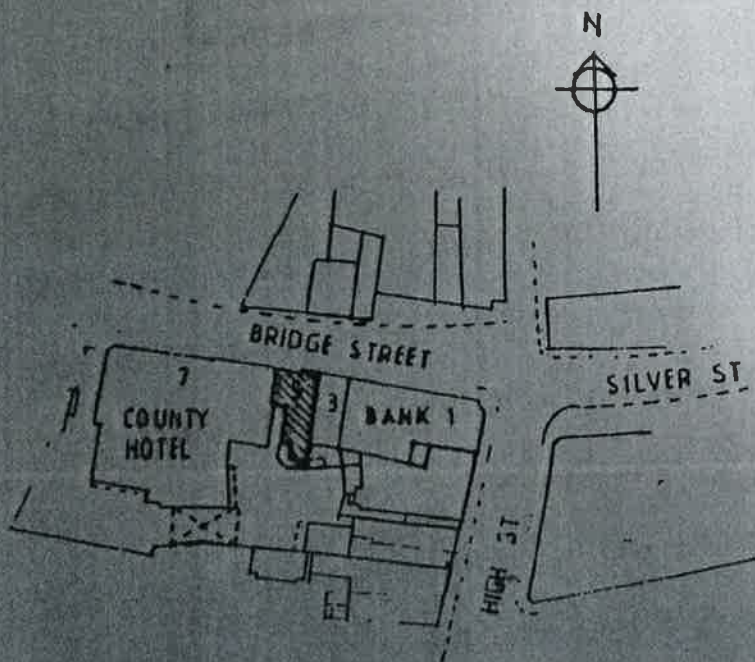

SITE PLAN 1:1250

COPY

LICENSING AUTHORITY
CERTIFIED COPY *Jan Garrod*
DATE 26.6.18